

CONSTRUCTED SPINE ROAD

SHD APPLICATION

POSSIBLE FUTURE DEVELOPMENT 3RD PARTY LANDS

SPINE ROAD (ARTERIAL)
SCALE: H 1:2000 V 1:200
DATUM: 95.000

Chainage	Existing Levels	Proposed Levels	Level Difference	Vertical Geometry	Horizontal Geometry
200.000	96.770	97.350	0.580	$R = -0.500\%$ $L = 47.335$ $K = 47.046$ $L = 63.772$	$R = 184.824$ $L = 183.232$
225.000	96.668	97.225	0.565		
250.000	96.761	97.120	0.359	$R = -4704.561$ $L = 47.335$ $K = 47.046$ $L = 63.772$	$R = 184.824$ $L = 183.232$
275.000	97.049	97.134	0.085		
300.000	97.602	97.280	-0.322	$R = -0.865\%$ $L = 268.320$	$R = 184.824$ $L = 183.232$
325.000	97.945	97.494	-0.450		
350.000	98.385	97.708	-0.677	$R = -0.865\%$ $L = 268.320$	$R = 184.824$ $L = 183.232$
375.000	97.881	97.922	0.041		
400.000	97.949	98.136	0.187	$R = -0.865\%$ $L = 268.320$	$R = 184.824$ $L = 183.232$
425.000	97.949	98.350	0.400		
450.000	98.101	98.564	0.463	$R = -0.865\%$ $L = 268.320$	$R = 184.824$ $L = 183.232$
475.000	98.258	98.778	0.520		
500.000	98.911	98.992	0.081	$R = -0.865\%$ $L = 268.320$	$R = 184.824$ $L = 183.232$
525.000	99.052	99.205	0.153		
550.000	99.244	99.419	0.175	$R = -0.865\%$ $L = 268.320$	$R = 184.824$ $L = 183.232$
575.000	99.522	99.637	0.115		
600.000	99.676	99.939	0.262	$R = -0.865\%$ $L = 268.320$	$R = 184.824$ $L = 183.232$
625.000	100.429	100.357	-0.063		
650.000	100.538	100.891	0.353	$R = -5367.977$ $L = 47.335$ $K = 53.680$ $L = 63.772$	$R = 184.824$ $L = 183.232$
675.000	101.299	101.512	0.220		
700.000	102.190	102.137	-0.053	$R = -2.489\%$ $L = 111.111$ $K = 58.198$	$R = 184.824$ $L = 183.232$
725.000	103.005	102.762	-0.243		
750.000	103.800	103.387	-0.412	$R = -2.501\%$ $L = 111.111$ $K = 58.198$	$R = 184.824$ $L = 183.232$
775.000	104.466	103.951	-0.509		
800.000	104.931	104.325	-0.606	$R = -2.501\%$ $L = 111.111$ $K = 58.198$	$R = 184.824$ $L = 183.232$
825.000	104.953	104.506	-0.448		
850.000	104.884	104.492	-0.392	$R = -2.501\%$ $L = 111.111$ $K = 58.198$	$R = 184.824$ $L = 183.232$
875.000	104.884	104.285	-0.247		
900.000	103.844	103.884	0.041	$R = -2.489\%$ $L = 111.111$ $K = 58.198$	$R = 184.824$ $L = 183.232$
925.000	102.742	103.301	0.559		
950.000	101.684	102.680	0.996	$R = -2.489\%$ $L = 111.111$ $K = 58.198$	$R = 184.824$ $L = 183.232$
975.000	101.106	102.148	1.042		
1000.000	100.468	101.738	1.271	$R = -2.489\%$ $L = 111.111$ $K = 58.198$	$R = 184.824$ $L = 183.232$
1025.000	100.314	101.373	1.059		
1050.000	100.180	101.008	0.829	$R = -2.489\%$ $L = 111.111$ $K = 58.198$	$R = 184.824$ $L = 183.232$
1075.000	100.099	100.643	0.544		
1100.000	100.036	100.278	0.242	$R = -2.489\%$ $L = 111.111$ $K = 58.198$	$R = 184.824$ $L = 183.232$
1125.000	100.009	99.913	-0.087		
1150.000	99.547	99.547	0.000	$R = -2.489\%$ $L = 111.111$ $K = 58.198$	$R = 184.824$ $L = 183.232$
1175.000	99.951	99.182	-0.769		
1200.000	99.551	98.817	-0.734	$R = -2.489\%$ $L = 111.111$ $K = 58.198$	$R = 184.824$ $L = 183.232$
1225.000	99.014	98.452	-0.559		
1250.000	98.453	98.087	-0.367	$R = -2.489\%$ $L = 111.111$ $K = 58.198$	$R = 184.824$ $L = 183.232$
1275.000	98.061	97.722	-0.339		
1300.000	97.171	97.356	0.186	$R = -2.489\%$ $L = 111.111$ $K = 58.198$	$R = 184.824$ $L = 183.232$
1325.000	96.509	96.991	0.491		
1350.000	96.541	96.826	0.285		

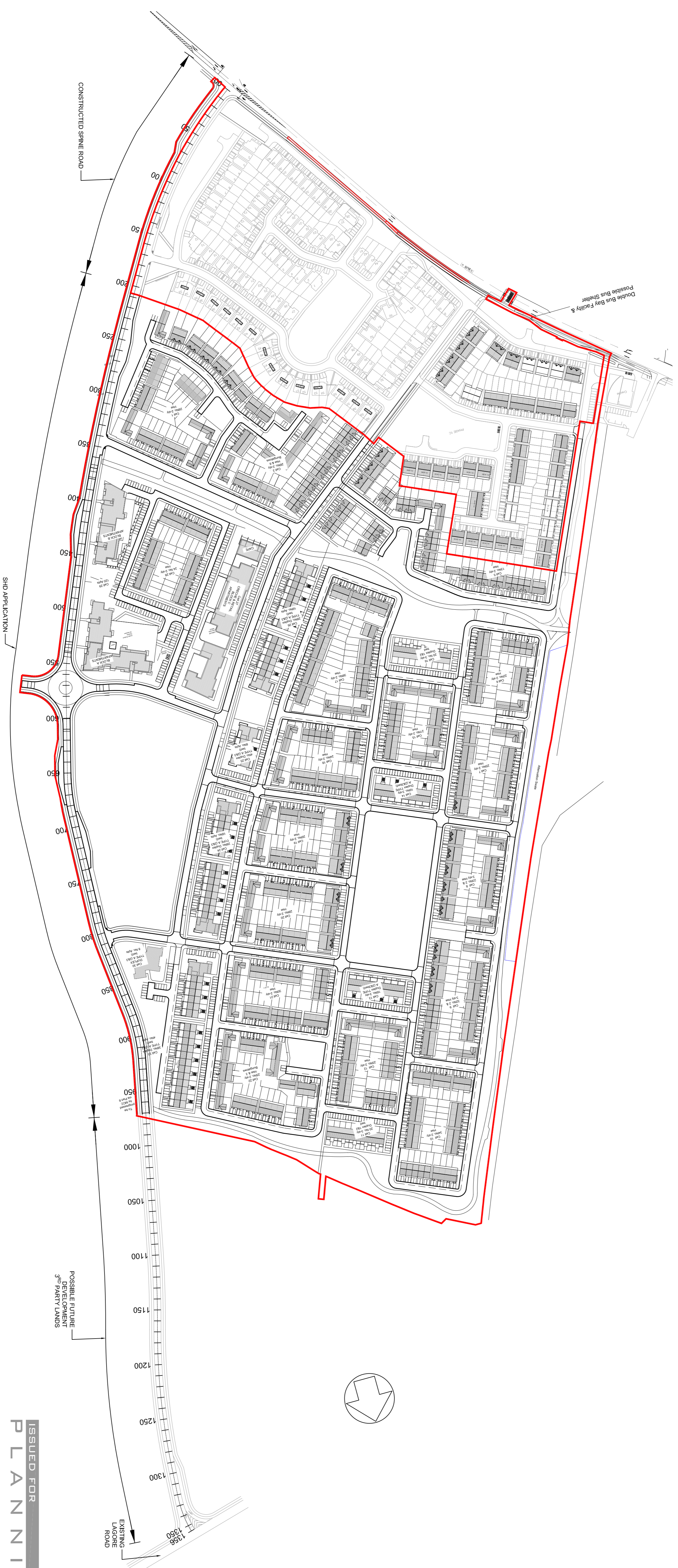

DIMENSIONS

Figure dimensions only to be taken from this drawing. All dimensions to be checked on site. Architects to be informed immediately of any discrepancies before work proceeds.

NOTES:

© COPYRIGHT
This drawing and any design hereon is copyright of JOR Consulting Engineers and must not be reproduced in whole or in part without their express written consent.

ISSUED FOR PLANNING

JOR
Joseph O'Reilly
Consulting Civil & Structural Engineers
Unit 1, St. Theresa's Place, Flowerhill, Navan, Co. Meath
Tel: 046 9077092 Fax: 046 9077932
Email: mail@jor.ie Web: www.jor.ie

CLIENT	Rocktore1 Limited
PROJECT	Proposed Strategic Housing Development at Dunshaughlin East
TITLE	Arterial (Spine) Road Vertical & Horizontal Alignment
SCALE	1:2000 @ A1
DATE CREATED	November 2018
DATE CHECKED	
DRAWN BY:	SC
CHECKED BY:	MS
JOB No.	J18-001
DRAWING No.	037
REV	A